

OMNI DIRECTIONAL LIGHTING

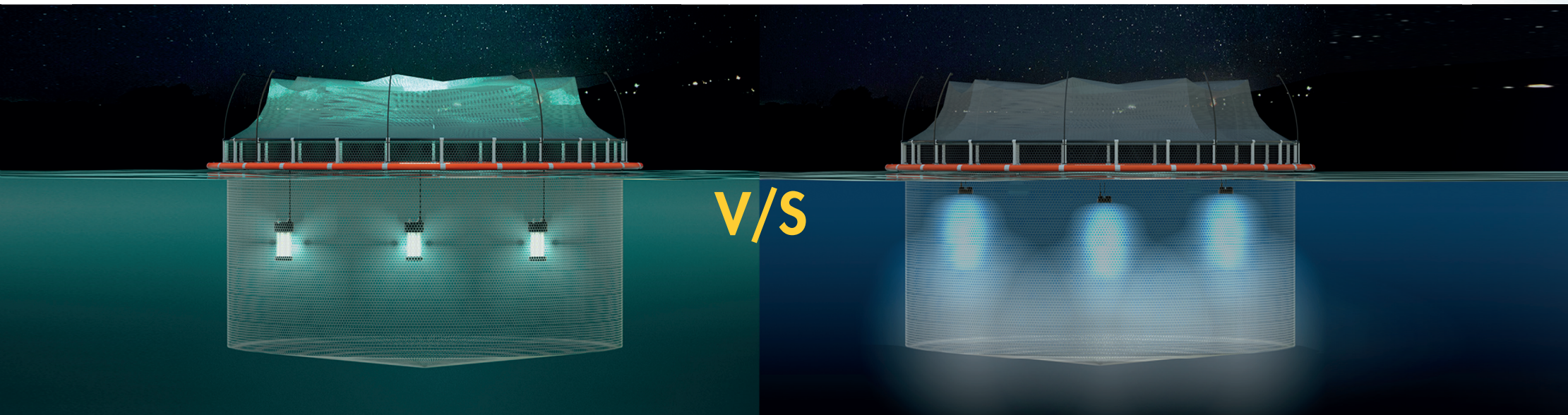

DIRECT LIGHTING TEMPEST PHOTOPERIOD

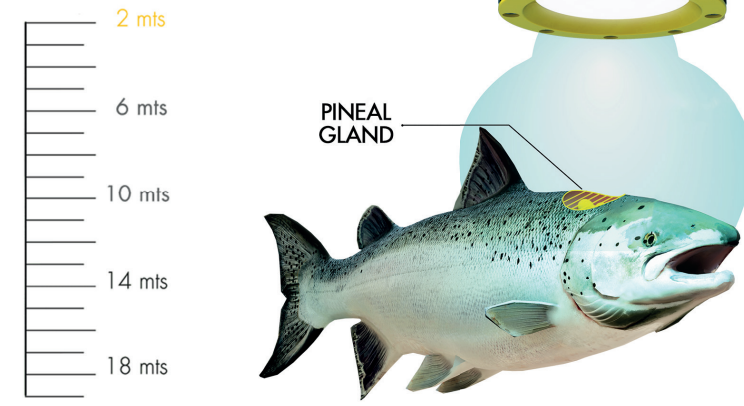

EVOLUX

lighting

SMART & ROBUST
PHOTOPERIOD

TEMPEST

 MADE IN CHILE

- › 6 to 8 meters installation.
- › Wasted energy that is not delivered directly to the pineal gland.
- › Greater loss as light pollution to the skies.
- › Less real coverage, only 2 to 3 meters effective above and below the lamp.

- › 3 to 5 meters installation.
- › Excellent energy received directly by the pineal gland of the fish.
- › Full spectrum color delivery.
- › Greater reach in depth, >20 meters.
- › Less light pollution to the sky.



**TEMPEST
IP68 / 69K**

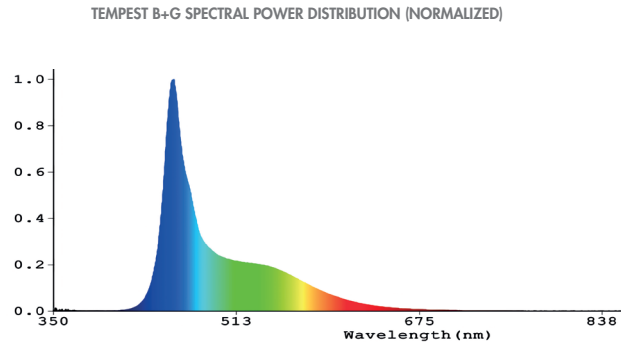
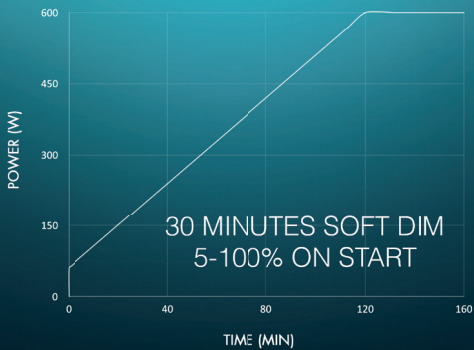

Model	350W	500W	700W
Radiant Power [W]	194,34	277,10	378,96
Peak Wavelength	455nm		
Blue [%]	19.7		
Green [%]	76.2		
Red [%]	4.1		
Total Efficiency	57,8%	55,4%	54,1%

TECHNICAL SPECIFICATIONS

LED OPTICAL SOURCE	CREE. SALMONOID PINEAL GLAND SPECTRUM OPTIMIZATION
DRIVER INPUT	90-310 VAC (50/60Hz) 3.0Amax
POWER INPUT	350W / 500W / 700W
PROTECTIONS	OVP, OCP, OTP, SHORT CIRCUIT, SELV
ISOLATION	6kV DM (input), 10kV CM (output)
LED INPUT	3.6A / 5.4A / 7.9A @85-95 VDC
LAMP PROTECTION	SELF OVER TEMPERATURE TURN OFF
CONTROLS	AUTOMATIC / 0-10V DIM TO OFF / DALI-2 / PLC
LIFESPAN	120.000Hrs (DRIVER) / 100.000Hrs (LED SOURCE)
DIMMENSIONS	65MM (H), 180M (OD)
NET WEIGHT	3.2KG (AIR), 1.8KG (UNDERWATER) *Without cable.
MATERIAL	PURE ALUMINUM, NANO CERAMIC COAT. ANTIFOULING TOP COAT
OPTIC	10MM TEMPERED BOROSILICATE IEC 600-79. SELF CLEANING

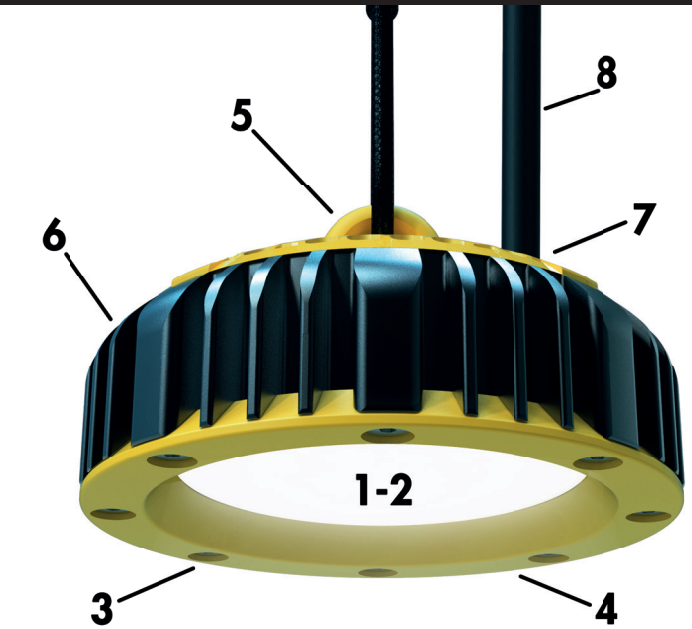
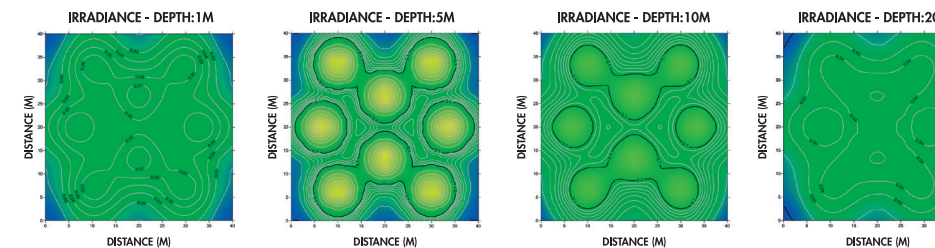
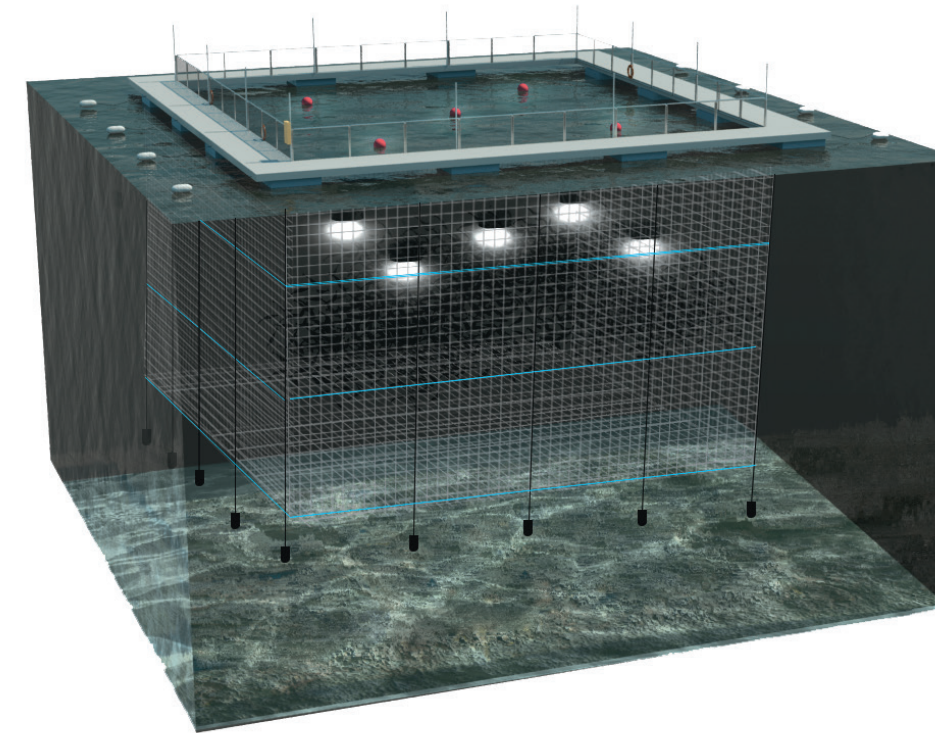

- 1) Optimized LED source moisture protected. Thermal protection.
- 2) 10mm Tempered Borosilicate / Silicone O-ring. IK10.
- 3) Stainless Steel 316L screws + NanoCeramic.
- 4) Aluminum 500uM technical plastic coating.
- 5) 50mm eyebolt with 500uM plastic coat.
- 6) 1070 Pure aluminum / Elite Cerakote coat + antifouling top coat.
- 7) Wiska Sprint Gland IP68 / PUR Resin.
- 8) Submarine TPU Yellow cable.
- 9) Plug&Play TE Nector T IP68 Connectors.

Laser Marking: Technical Specs, Manufacturing Date, Serial Number.
Customer Logo: Optional.

Tests and Certifications:
CSA C22.1 #89 (Canada). UL 676 **Cesmec:** Photometric Curves, Efficiency, IK, Salinity ASTM B117-09 168Hours. **EVOLUX LAB:** IK, Light Spectrum, Photometric Curves, IPX8 135M, Efficiency, Electrical Safety.