

## MC025S ON-OFF Function / Occupancy Sensor



### Introduction

- Automatic switching based on motion and ambient light level.
- Thanks to occupancy detection design, perfect for office ,classroom application.
- Zero-crossing point operation helps protect the sensor against in-rush current.
- 5.8GHz high frequency microwave(C-Band license-free operation)
- Detection area, time delay and daylight threshold can be precisely set via DIP switch.

MC025S is an innovative motion sensor, originally pioneered by Merrytek , switch on the light on detection of movement, and switch off a hold time when there is no motion detected. As built-in daylight sensor can read brightness value, the sensor does not switch on the light if with sufficient in natural light.

The sensor supplies a simple energy-saving solution to use light only when and where you need it. It automatically switches on/off light based on motion and ambient light level. Can control all kinds of lamps, for example, halogen, fluorescent and LED lights. Compact size and small casing, suitable to fix within most luminaires.



Max.4M



Zero-crossing  
point operation



Light Sensor



Hold Time  
10s~30min

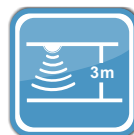

Mounting Height  
3m Max.



Automatic  
On/Off



5 Years  
Guarantee

## ON -OFF Function

MC025S is an innovative motion sensor, integrated with slight motion detector, any slight motion such as typing on keyboard or taking note will be detected.



With sufficient light ,the lamp doesn't switch on even there is movement .

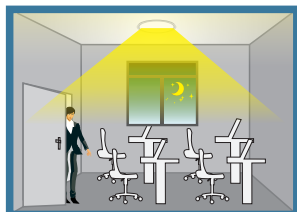

With insufficient light ,the lamp switch on when there is movement .



Any motion such as typing on keyboard or taking note detected,the lamp keeps on.



When people leave,the light switch off .

### Wiring scheme

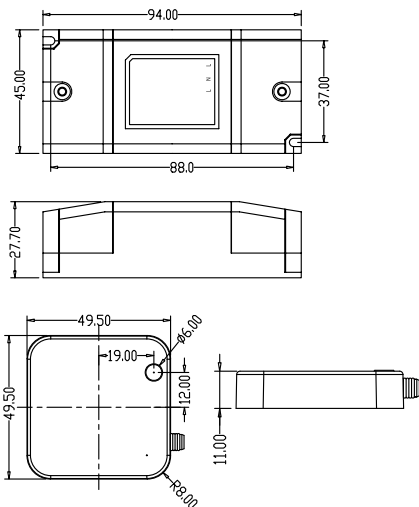
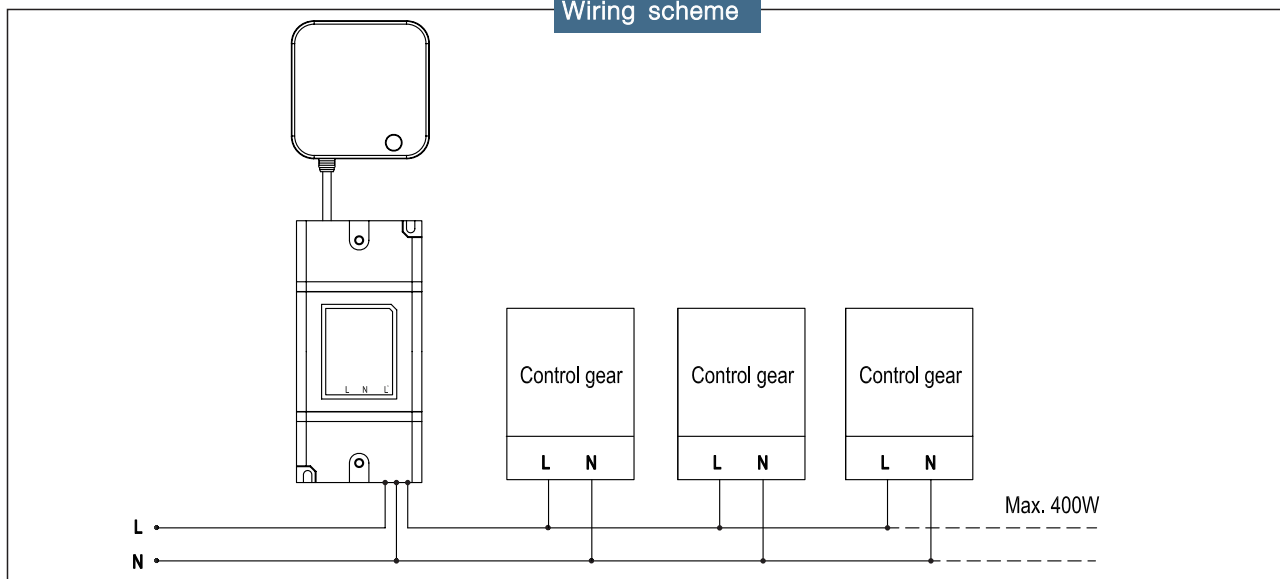

### MC025S

Operating voltage	220-240Vac, 50Hz
Rated load	400W(Inductive), 800W (resistive)
HF system	5.8GHz±75MHz, ISM wave band
Power consumption	≤0.5W(standby), <1W(operation)
Transmitting power	<0.5mW
Detection zone Max.(D x H)	8m x 3m
Operation Temperature	-30℃ ~70℃
Hold time	10s/3min/5min/10min/15min/30min
Daylight sensor	5lux / 10lux / 30lux / 50lux / Disable
Detection angle	150°(wall installation) 360°(ceiling installation)
IP rating	IP65

## Setting

By selecting the combination on the DIP switch, sensor data can be precisely set for each specific application.

	1	2	3	
ON ↑ 	ON	ON	ON	10S
	-	ON	ON	3min
	ON	-	ON	5min
	-	-	ON	10min
	ON	ON	-	15min
	-	-	-	30min

### Hold time

Refers to the time period the lamp remains at 100% illumination after no motion detected.

ON ↑ 	1	2	3	
	ON	ON	ON	Disable
	ON	ON	—	50LUX
	—	ON	—	30LUX
	ON	—	—	10LUX
	—	—	—	5LUX

### Daylight sensor

The sensor can be set to only allow the lamp to illuminate below a defined ambient brightness threshold.

When set to Disable mode, the daylight sensor will switch on the lamp when motion is detected regardless of ambient light level.

50lux, 30lux: twilight operation, 10lux, 5lux: darkness operation only.